



9B45VMN3366

BRANCH METERED PDU

SPECIFICATIONS

DIMENSIONS L x W x D = 1490 x 65 x 52.5 mm (0U)
(excl. strain relief, mounting & cable bending radius)

ENCLOSURE Profile color black, aluminium with stainless steel covers (IP20)

MOUNT Toolless mount buttons (brackets not included)
(distance=1066, positions=212, 1278mm)

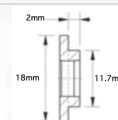

POWER INPUT three phase 32 A, 230/400V - 50/60Hz

CABLE ENTRY power entry side-cover top

CABLE & PLUG Power lead (5G6 halogenfree) with CEE plug 3,0m (strain relief height 2,5cm)



CONNECTIVITY databus: 2 x RJ45 | Ethernet: RJ45 | sensorport: RJ12 | USB

BRANCH METERING 6 x volt, ampere, kWh, power factor

FUSES 6 x Thermal breaker 16A (ETA)

DISPLAY LCD display with backlight and configurable orientation

OUTLETS 30 x IEC 60320 C13 , 6 x IEC 60320 C19

Summary:

- vertical PDU (0 U)
- three phase 32 A
- metered branches (6x)
- 36 outlets