



**SCHLEIFENBAUER**  
LIVING FOR THE POWER TO DELIVER



## 78A6VMS1322

SWITCHED PDU

### SPECIFICATIONS

DIMENSIONS	L x W x D = 1465 x 65 x 52.5 mm (0U) (excl. strain relief, mounting & cable bending radius)
ENCLOSURE	Profile color black, aluminium with stainless steel covers (IP20)
MOUNT	Toolless mount buttons (brackets not included) (distance=1067, positions=199, 1266mm)
POWER INPUT	single phase 32 A, 230VAC - 50/60Hz
CABLE ENTRY	power entry side-cover top
CABLE & PLUG	Power lead (3G6 halogenfree) with CEE plug 3,0m (strain relief height 2,5cm)
CONNECTIVITY	databus: 2 x RJ45   Ethernet: RJ45   sensorport: RJ12   USB
BRANCH METERING	2 x volt, ampere, kWh, power factor
SWITCHED OUTLETS	24 times bistable close to zero crossing switching relays
FUSES	2 x Thermal breaker 16A (ETA)
DISPLAY	LCD display with backlight and configurable orientation
OUTLETS	24 x IEC 60320 C13 (IEC Lock)

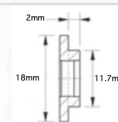

#### Summary:

- vertical PDU (0 U)
- single phase 32 A
- metered branches (2x)
- switched outlets
- 24 outlets

